

YSV200. M5

Direct Actuated
Staking Body Valves

- 3/2- Direct Operation Type
- High Durability
- Orifice \varnothing 1.1mm

SPECIFICATION

| ITEM | FUNCTION | SERIES | YSV211 | YSV221 |
|-------------------------------|----------|--|--|---------|
| | | FUNCTION | 3/2-N.C | 3/2-N.O |
| Fluids | | Compressed Air & Inert Gases | | |
| Pressure(bar) | | 0~8,0 | | |
| Orifice(mm) | | P = \varnothing 1.1, R = \varnothing 1.2 | P = \varnothing 1.2, R = \varnothing 1.1 | |
| Ambient & Fluid Temp. | | 5~60°C (41~140°F) | | |
| Response Time(5bar) | | 20ms or Less | | |
| Max. Working Frequency | | 8c/sec | | |
| Lubrication | | Not Required(Use ISO VG32 #) | | |
| Manual Override | | Push Button(Standard), Lever Lock(Optional) | | |
| Coil Insulation Class | | F-Class or Equivalent | | |
| Permissible Voltage Variation | | \pm 10% of Rated Voltage | | |
| Off Min. Residual Voltage | | AC:20% or Less / DC:10% or Less | | |
| Power Consumption | | AC:3.5VA(60Hz) / DC:2.5W | | |

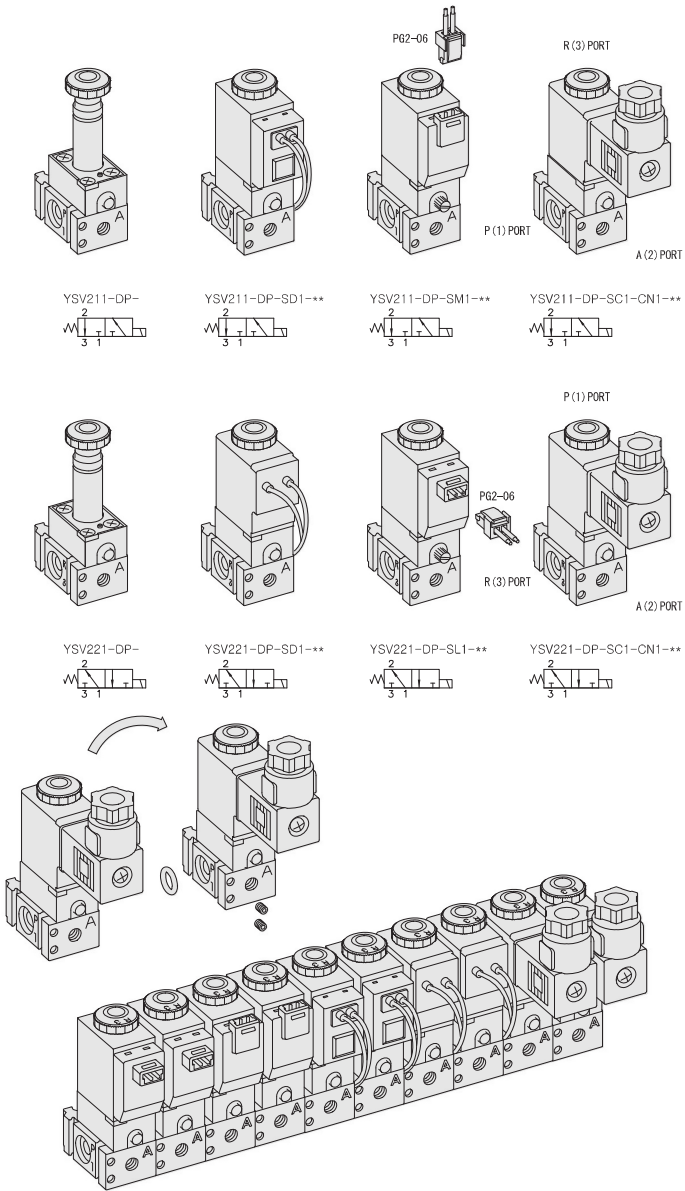

** : Voltage Selection (see page 80)

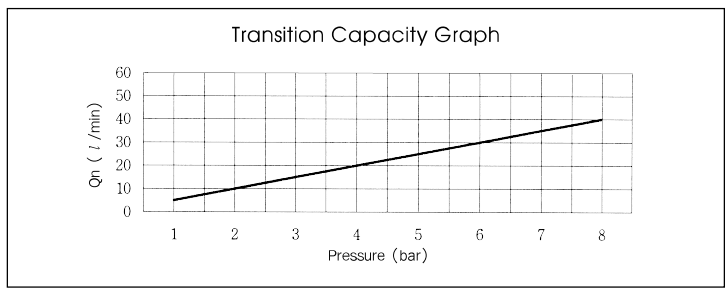

- ### The Material of Parts
- Valve Body : Aluminium
 - Pilot Parts : Glass Filled Nylon
 - Pilot Plate : Zinc Pressure Die-Cast
 - Spring : Stainless
 - Seals : NBR
 - Armature : Stainless Steel
 - Armature Seals : Viton

Plug Connector With Clip

Ordering Code
 PG2-06 (L : 600mm)
 PG2-10 (L : 1,000mm)

* The specification on each item can be amended without any prenotice to improve a performance.
 * The specification on each item can be different from actual specification.

ORDERING NO.

YSV2 1 1 - D P - SC1 - CN1 - A2

| Valve Series | Function | Port Size & Thread | Pilot Source | Manual Operator | Solenoid Coil Type | Connector Type | Voltage |
|--------------------------|----------|-----------------------------------|--------------|-------------------------|---|---|------------|
| YSV2 : Solenoid Valve | 1 | 3/2 Normally Closed Spring Return | 1 M5x0,8 | D Direct Operated | P Push Non-Locking Override | 0 None | 0 None |
| | 2 | 3/2 Normally Open Spring Return | 2 10-32 UNF | L LeverLocking Override | SC1 3 Pin Connector Coil | CN1 Normal Connector | A2 AC 220V |
| | | | | | SG1 Grommet/Flying Leads | CD1 Connector With LED | A1 AC 110V |
| | | | | | SD1 Grommet/Flying Leads With LED | CZ1 Connector With LED & Surge Suppressor | A4 AC 24V |
| | | | | | SL1 90 Degree Plug-in Wire Assembly with LED | | D4 DC 24V |
| | | | | | SM1 180 Degree Plug-in Wire Assembly with LED | | D2 DC 12V |

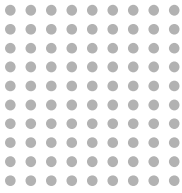

Direct Solenoid Actuated Valves

Port Thread **M5 × 0.8**

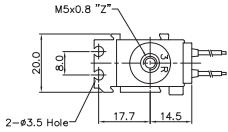

| PORT | TYPE | N.C | N.O |
|------|------|------|------|
| X | P(1) | R(3) | |
| Y | A(2) | A(2) | |
| Z | R(3) | | P(1) |

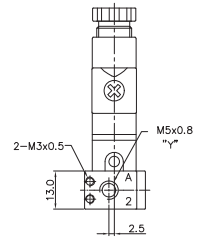
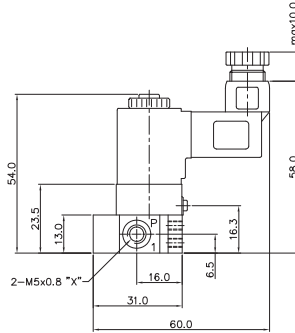
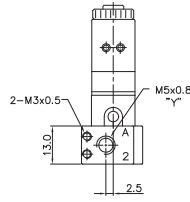
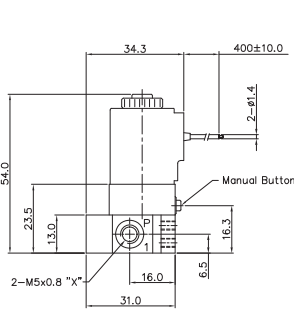
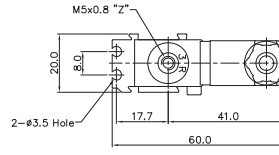

YSV211-DP-SG1-***
Normally Closed

YSV221-DP-SG1-***
Normally Open

YSV211-DP-SC1-CN1-***
Normally Closed

YSV221-DP-SC1-CN1-***
Normally Open

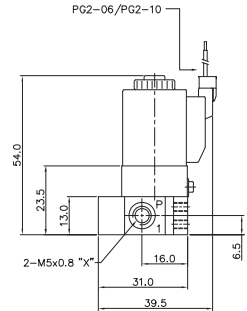
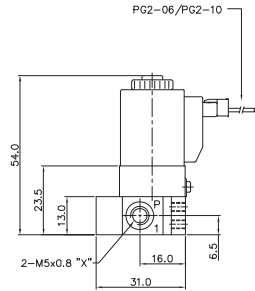
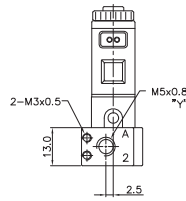
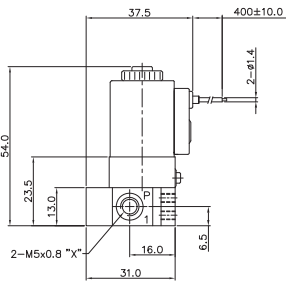

YSV211-DP-SD1-***
Normally Closed

YSV221-DP-SD1-***
Normally Open

YSV211-DP-SL1-***
Normally Closed

YSV221-DP-SL1-***
Normally Open

YSV211-DP-SM1-***
Normally Closed

YSV221-DP-SM1-***
Normally Open

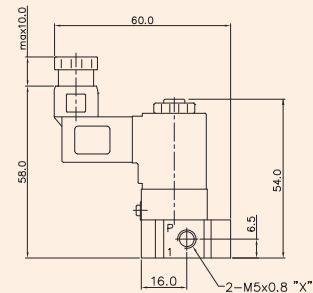
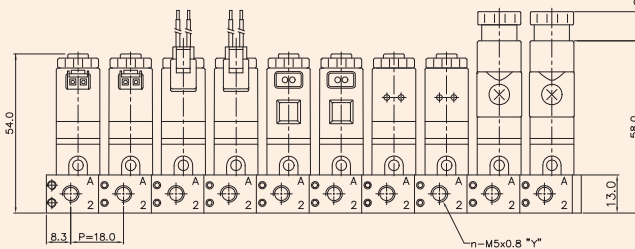
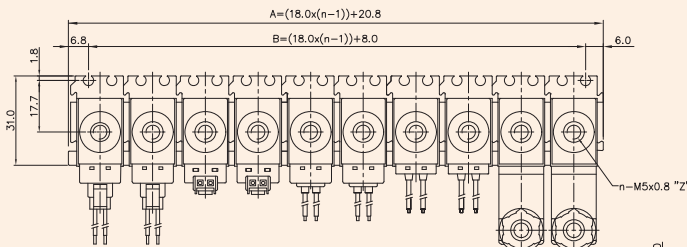
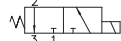

A, B = DIMENSIONS

n = STATION

| ITEM | n | 2 | 3 | 4 | 5 | 6 | 7 | 8 | 9 | 10 |
|------|---|------|------|------|------|-------|-------|-------|-------|-------|
| A | | 38.8 | 56.8 | 74.8 | 92.8 | 110.8 | 128.8 | 146.8 | 164.8 | 182.8 |
| B | | 26.0 | 44.0 | 62.0 | 80.0 | 98.0 | 116.0 | 134.0 | 152.0 | 170.0 |

YSV300. 1/8

Direct Actuated
Staking Body Valves

- 3/2- Direct Operation Type
- High Durability
- Orifice \varnothing 1.5mm

SPECIFICATION

| ITEM | SERIES | YSV311 | YSV321 |
|-------------------------------|---|--|--|
| FUNCTION | | 3/2-N.C | 3/2-N.O |
| Fluids | Compressed Air & Inert Gases | | |
| Pressure(bar) | 0~8,0 | | |
| Orifice(mm) | | P = \varnothing 1.5, R = \varnothing 1.5 | P = \varnothing 1.5, R = \varnothing 1.5 |
| Ambient & Fluid Temp. | 5~60°C (41~140°F) | | |
| Response Time(5bar) | 20ms or Less | | |
| Max. Working Frequency | 8c/sec | | |
| Lubrication | Not Required(Use ISO VG32 #) | | |
| Manual Override | Push Button(Standard), Lever Lock(Optional) | | |
| Coil Insulation Class | F-Class or Equivalent | | |
| Permissible Voltage Variation | \pm 10% of Rated Voltage | | |
| Off Min. Residual Voltage | AC:20% or Less / DC:10% or Less | | |
| Power Consumption | AC:3.5VA(60Hz) / DC:2.5W | | |

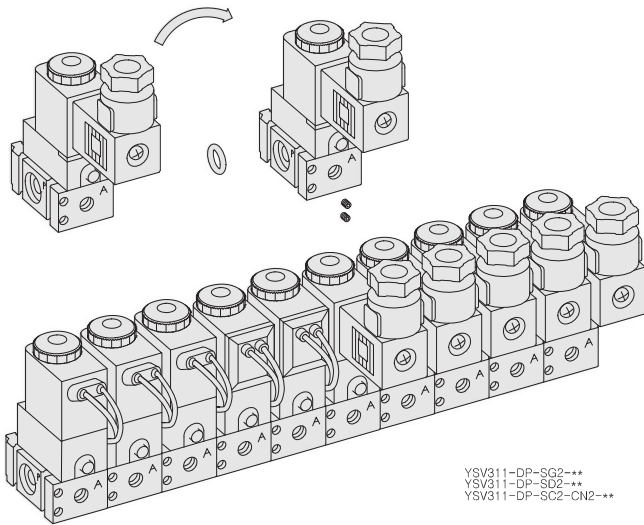
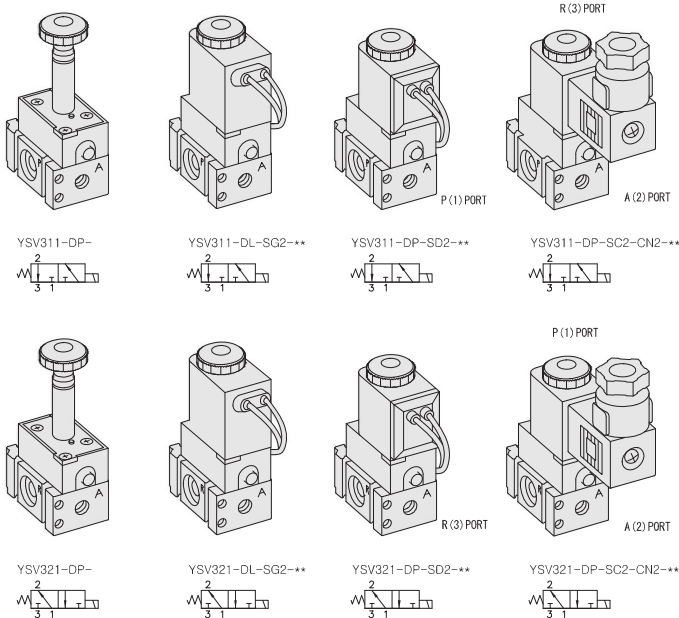

YSV311-DP-SG2-**
YSV311-DP-SD2-**
YSV311-DP-SC2-CN2-**

** : Voltage Selection (see page 80)

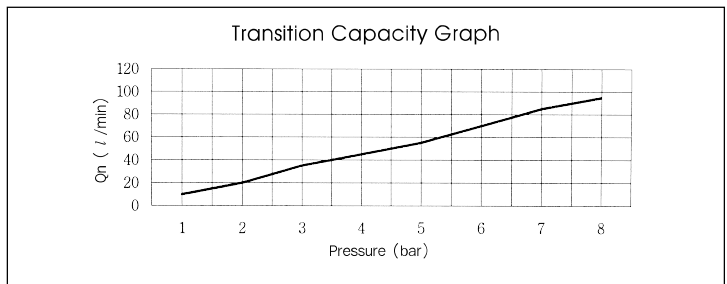

The Material of Parts

| | |
|--|------------------------------|
| ■ Valve Body : Aluminium | ■ Armature : Stainless Steel |
| ■ Pilot Parts : Glass Filled Nylon | ■ Armature Seals : Viton |
| ■ Pilot Plate : Zinc Pressure Die-Cast | |
| ■ Spring : Stainless | |
| ■ Seals : NBR | |

* The specification on each item can be amended without any prenotice to improve a performance.
* The specification on each item can be different from actual specification.

ORDERING NO.

YSV3 1 1 - D P - SC2 - CN2 - A2

| Valve Series | Function | Port Size & Thread | Pilot Source | Manual Operator | Solenoid Coil Type | Connector Type | Voltage |
|--------------------------|----------|----------------------|-------------------|-----------------------------|---|---|---|
| YSV3 : Solenoid Valve | 1 | 1 G 1/8 2 NPT 1/8 | D Direct Operated | P Push Non-Locking Override | 0 None SC2 3 Pin Connector Coil | 0 None CN2 Normal Connector | 0 None A2 AC 220V |
| | 2 | | | L Lever Locking Override | SG2 Grommet/Flying Leads SD2 Grommet/Flying Leads With LED | CD2 Connector With LED C22 Connector With LED & Surge Suppressor | A1 AC 110V A4 AC 24V D4 DC 24V D2 DC 12V |

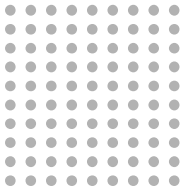

Direct Solenoid Actuated Valves

Port Thread 1/8

| PORT | TYPE | N.C | N.O |
|------|------|------|-----|
| X | P(1) | R(3) | |
| Y | A(2) | A(2) | |
| Z | R(3) | P(1) | |

YSV310-DP-SD2-**
 Normally Closed

YSV320-DP-SD2-**
 Normally Open

YSV310-DP-SG2-**
 Normally Closed

YSV320-DP-SG2-**
 Normally Open

YSV310-DP-SC2-CN2-**
 Normally Closed

YSV320-DP-SC2-CN2-**
 Normally Open

$A = (24.8n + 4.0)$
 $B = (24.8n - 11.2)$

A, B = DIMENSIONS

| ITEM | n | 2 | 3 | 4 | 5 | 6 | 7 | 8 | 9 | 10 |
|------|---|------|------|-------|-------|-------|-------|-------|-------|-------|
| A | | 53.6 | 78.4 | 103.2 | 128.0 | 152.8 | 177.6 | 202.4 | 227.2 | 252.0 |
| B | | 38.4 | 63.2 | 88.0 | 112.8 | 137.6 | 162.4 | 187.2 | 212.0 | 236.8 |

n = STATION